

**LMEF\_L SERIES (EUROPE SERIES)**

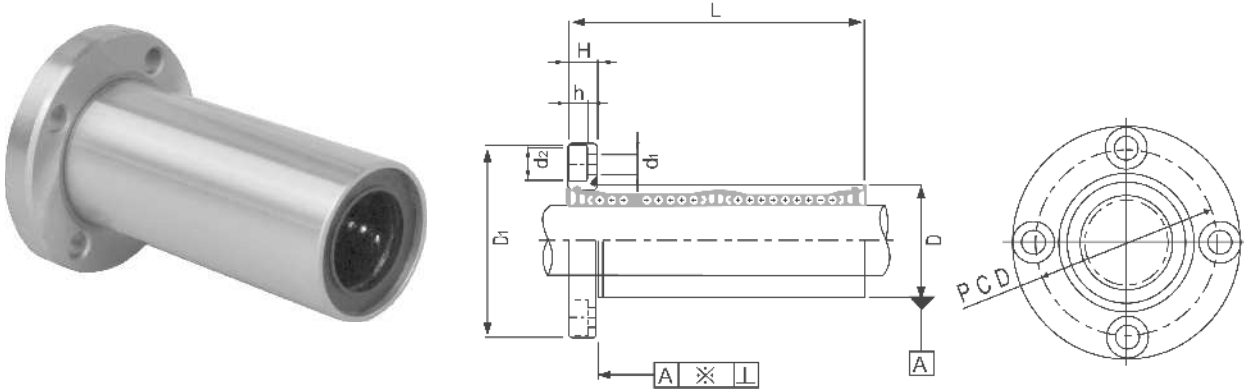

Tipul	Ball circuit	dr		D		L (±0,3)	D1	PCD	H	d1xd2xh	Eccentricity (max.)	Radial clearance (max.)	Load		Weight
		(mm)	(µm)	(mm)	(µm)								C	C0	
LMEF8LUU	4	8	+9	16	0 / -13	46	32	24	5	3,5x6x3,1		-3	421	804	59
LMEF12LUU	4	12	+1	22	0	61	42	32	6	4,5x7,5x4,1	15	-4	813	1570	110
LMEF16LUU	5	16	+11	26	-16	68	46	36	6	4,5x7,5x4,1		-6	921	1780	160
LMEF20LUU	5	20	+1	32		80	54	43	8	5,5x9x5,1		-6	1370	2740	260
LMEF25LUU	6	25	+13	40	0	112	62	51	8	5,5x9x5,1	17	-6	1570	3140	540
LMEF30LUU	6	30	-2	47	-19	123	76	62	10	6,6x11x6,1		-8	2500	5490	815
LMEF40LUU	6	40		62	0	151	98	80	13	9x14x8,1	20	-8	3430	8040	1805
LMEF50LUU	6	50	+16	75	-22	192	112	94	13	9x14x8,1		-13	6080	15900	2820
LMEF60LUU	6	60	-4	90	0 / -25	209	134	112	18	11x17x11,1	25	-13	7550	20000	4920